

NOTES

- (1) THE INFORMATION CONTAINED ON THIS DOCUMENT IS COPYRIGHT AND MAY NOT BE COPIED, DISSEMINATED OR USED FOR ANY OTHER PURPOSE OTHER THAN THAT FOR WHICH IT HAS BEEN PROVIDED WITHOUT THE WRITTEN PERMISSION OF CAMERON GIBSON & WELLS LTD
- (2) VERIFY ALL DIMENSIONS ON SITE
- (3) DO NOT SCALE FROM DRAWING
- (4) THE ADEQUACY OF THE DESIGN INCORPORATED ON THE PLANS IS SUBJECT TO THE REQUIREMENTS INCLUDED IN THE SPECIFICATION FOR THE WORKS AND THE DESIGN ASSUMPTIONS INCORPORATED IN THE CALCULATIONS AND REPORTS FOR THE PROJECT

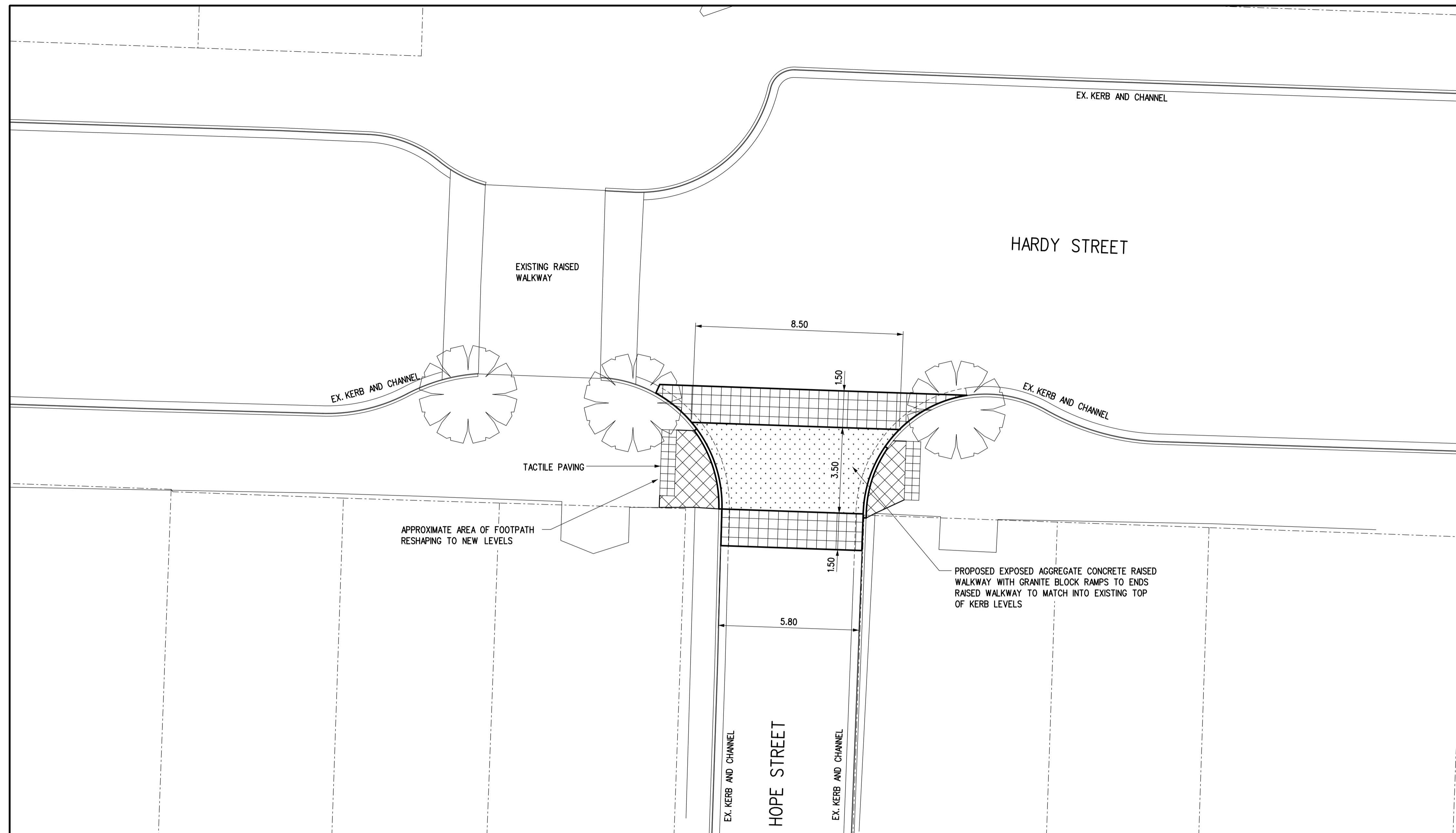

LAYOUT PLAN

1:100 (A1)
1:200 (A3)

A	7.12.10	FOR CONSULTATION	MJS	MJS	RP	RP
NO	DATE	REVISION	DES	DRN	CHD	APD

CAMERON GIBSON & WELLS LTD

CONSULTING CIVIL & STRUCTURAL ENGINEERS
PH. 548-8259 NELSON FAX 546 8412
EMAIL cgw@extra.co.nz

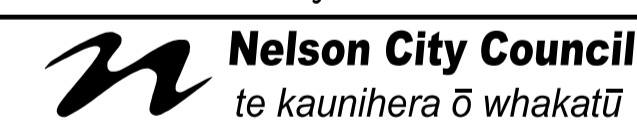

APPROVED
EXECUTIVE MANAGER NETWORK SERVICES

DATE

JOB TITLE
**NELSON CITY COUNCIL
HEART OF NELSON
RAISED WALKWAYS**

DRAWING TITLE
**HARDY ST - HOPE ST
RAISED WALKWAY
CONSULTATION PLAN**

SCALE	1:100 (A1) 1:200 (A3)	REVISION	A
-------	--------------------------	----------	---

JOB NO	13050-136	SHEET	CP4
--------	-----------	-------	-----

NOT FOR CONSTRUCTION